

# Air Powered Front Mount 5C Dead Length Collet Chucks

No Draw-tube or Air Feed Tubes required.  
For Lathes, Rotary Tables and Grinders:  
Series ATL206-5C



**Collet Chuck Order No. with Mount**  
ATL206-5C

**Straight Recess Mount Type A Mount**  
ATL206-5CA4  
ATL206-5CA5  
ATL206-5CA6  
ATL206-5CA8

**Straight Recess Mount Type D Mount**  
ATL206-5CD3  
ATL206-5CD4  
ATL206-5CD5  
ATL206-5CD6  
ATL206-5CD8

**Other Mounts**  
ATL206-5C43-2<sup>1</sup>/<sub>4</sub>-8  
ATL206-5C44-4<sup>o</sup>-Taper  
ATL206-5C45-2<sup>3</sup>/<sub>16</sub>-10  
ATL206-5C46-2<sup>3</sup>/<sub>8</sub>-6

**Collet Chuck Supplied with:**

- 2 Filter Bars
- 2 Air Hoses
- 1 Fixing Bracket for Hoses
- 1 5C Collet Wrench
- 1 Hex Key
- Mounting Bolts
- Users Manual

- No hydraulic system required
- No draw-tube or air feed tubes restricting spindle bore
- No rear cylinders and cylinder adapters
- Low cost
- Easily convert any lathe or grinder into a production machine
- Ideal for rotary table applications
- Change from collet chuck to standard chuck quick and easy
- High speed 5000 RPM
- High accuracy less than 0.005mm TIR
- Repeats on duplicate parts +/- 0.008mm
- Dead length design
- For best accuracy use high quality Crawford Collets
- Lever or foot pedal actuated
- Low maintenance with oil mist lubrication system
- High resistance to coolant and chip penetration
- Uses 5C Collets, range 1mm to 27mm
- Available in A, D, L, 4 degree, threaded and straight recess mounting

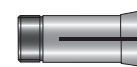
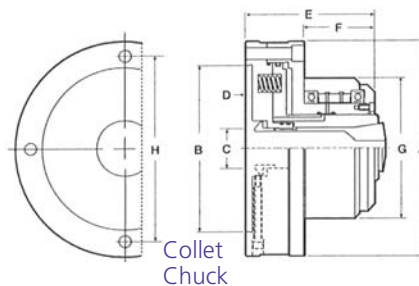

5C Collet

Collet Chuck	ATL206-5C	Specifications	ATL206-5C
A	168mm (6.61")	Screw Hole Dia	9mm (0.35") x 4
B	130mm (5.12")	Collet Type	5C Collets
C	26mm (1.02")	Max. RPM	5000
D	5mm (0.20")	Sleeve Stroke	4mm (0.16")
E	100mm (3.94")	Air Pressure	3-8 kg/cm <sup>2</sup> (42-114 psi)
F	55mm (2.17")	Through Hole Dia	26mm (1.06")
G	106mm (4.17")	Chuck Weight	10.6kg (22lbs)
H	147mm (5.79")	Grip Force	10,500 lbs @ 100 psi

**NOTE:**  
'E' shown is for model ATL206-5C Collet Chuck with no mounting plate. Add 3/4" to the 'E' dimension for mounting plate. This will vary slightly depending on the mounting required. If an exact 'E' dimension is required, consult factory.

**OPTIONS:**  
Order No: LEV100 Lever Control Package: Includes lever control, line filter, lubricator, and regulator.  
Order No: FOT200 Foot Pedal Control Package: Includes foot pedal, line filter, lubricator and regulator.

# Air Powered Front Mount 16C Dead Length Collet Chucks

No Draw-tube or Air Feed Tubes required.  
For Lathes, Rotary Tables and Grinders:  
Series ATL207-16C



**Collet Chuck Order No. with Mount**

ATL207-16CAP

**Straight Recess Mount Type A Mount**

ATL207-16CA5

ATL207-16CA6

ATL207-16CA8

**Straight Recess Mount Type D Mount**

ATL207-16CD4

ATL207-16CD5

ATL207-16CD6

ATL207-16CD8

**Other Mounts**

ATL207-16C44-4°-Taper

ATL207-16C45-2<sup>3</sup>/<sub>16</sub>-10

ATL207-16C46-2<sup>3</sup>/<sub>8</sub>-6

**Collet Chuck Supplied with:**

- 2 Filter Bars
- 2 Air Hoses
- 1 Fixing Bracket for Hoses
- 1 5C Collet Wrench
- 1 Hex Key
- Mounting Bolts
- Users Manual

- No hydraulic system required
- No draw-tube or air feed tubes restricting spindle bore
- No rear cylinders and cylinder adapters
- Low cost
- Easily convert any lathe or grinder into a production machine
- Ideal for rotary table applications
- Change from collet chuck to standard chuck quick and easy
- High speed 4000 RPM
- High accuracy less than 0.005mm TIR
- Repeats on duplicate parts +/- 0.008mm
- Dead length design
- For best accuracy use high quality Crawford Collets
- Lever or foot pedal actuated
- Low maintenance with oil mist lubrication system
- High resistance to coolant and chip penetration
- Uses 16C Collets, range 1.5mm to 42.5mm
- Available in A, D, L, 4 degree, threaded and straight recess mounting

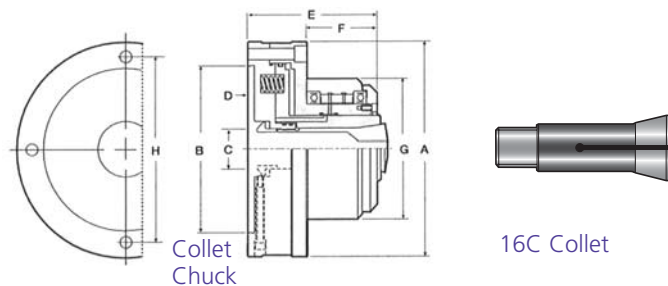

Collet Chuck	ATL207-16C	Specifications	ATL207-16C
A	188mm (7.40")	Screw Hole Dia	9mm (0.35") x 4
B	150mm (5.91")	Collet Type	16C Collets
C	40mm (1.57")	Max. RPM	4000
D	5mm (0.20")	Sleeve Stroke	4mm (0.16")
E	112mm (4.41")	Air Pressure	3-8 kg/cm <sup>2</sup> (42-114 psi)
F	63mm (2.48")	Through Hole Dia	40mm (1.57")
G	130mm (5.12")	Chuck Weight	14kg (30.8lbs)
H	168mm (6.61")	Grip Force	12,300 lbs @ 100 psi

**NOTE:**  
'E' shown is for model ATL207-16C Collet Chuck with no mounting plate. Add 3/4" to the 'E' dimension for mounting plate. This will vary slightly depending on the mounting required. If an exact 'E' dimension is required, consult factory.

**OPTIONS:**

Order No: LEV100 Lever Control Package: Includes lever control, line filter, lubricator, and regulator.  
Order No: FOT200 Foot Pedal Control Package: Includes foot pedal, line filter, lubricator and regulator.

# Air Powered Front Mount 173E Dead Length Collet Chucks

No Draw-tube or Air Feed Tubes required.  
For Lathes, Rotary Tables and Grinders:  
Series ATL207-B42



### Collet Chuck Order No. with Mount

ATL207-B42

### Straight Recess Mount Type A Mount

ATL207-B42A5

ATL207-B42A6

ATL207-B42A8

### Straight Recess Mount Type D Mount

ATL207-B42D4

ATL207-B42D5

ATL207-B42D6

ATL207-B42D8

### Other Mounts

ATL207-B4244-4°-Taper

ATL207-B4245-2<sup>3</sup>/<sub>16</sub>-10

ATL207-B4246-2<sup>3</sup>/<sub>8</sub>-6

### Collet Chuck Supplied with:

- 2 Filter Bars
- 2 Air Hoses
- 1 Fixing Bracket for Hoses
- 1 Hex Key
- Mounting Bolts
- Users Manual

- No hydraulic system required
- No draw-tube or air feed tubes restricting spindle bore
- No rear cylinders and cylinder adapters
- Low cost
- Easily convert any lathe or grinder into a production machine
- Ideal for rotary table applications
- Change from collet chuck to standard chuck quick and easy
- High speed 5000 RPM
- High accuracy less than 0.005mm TIR
- Repeats on duplicate parts +/- 0.008mm
- Dead length design
- For best accuracy use high quality Crawford Collets
- Lever or foot pedal actuated
- Low maintenance with oil mist lubrication system
- High resistance to coolant and chip penetration
- Uses 173E (Type: 4728-B42) Collets, range 2mm to 42mm
- Available in A, D, L, 4 degree, threaded and straight recess mounting

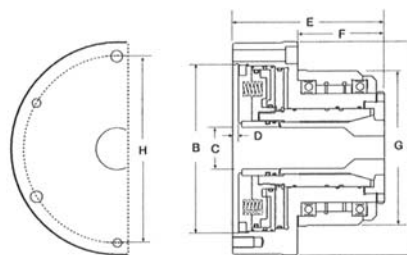

Collet Chuck

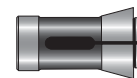

173E Collet

Collet Chuck	ATL207-B42	Specifications	ATL207-B42
A	196mm (7.72")	Screw Hole Dia	11mm (0.43") x 3 - M10xP1.5x3
B	155mm (6.10")	Collet Type	B42 Collets
C	42mm (1.65")	Max. RPM	4000
D	5mm (0.20")	Sleeve Stroke	4mm (0.16")
E	136mm (5.35")	Air Pressure	3-8 kg/cm <sup>2</sup> (42-114 psi)
F	75mm (2.95")	Through Hole Dia	42mm (1.65")
G	150mm (5.92")	Chuck Weight	16kg (35.2lbs)
H	172mm (6.77")	Grip Force	13,000 lbs @ 100 psi

**NOTE:**  
'E' shown is for model ATL207-B42 Collet Chuck with no mounting plate. Add 3/4" to the 'E' dimension for mounting plate. This will vary slightly depending on the mounting required. If an exact 'E' dimension is required, consult factory.

### OPTIONS:

Order No: LEV100 Lever Control Package: Includes lever control, line filter, lubricator, and regulator.  
Order No: FOT200 Foot Pedal Control Package: Includes foot pedal, line filter, lubricator and regulator.

# Air Powered 5C Stationary Dead Length Collet Chucks

Use for Pallets, Tombstones, Machining Centres, Standard Mills and Drill Presses:  
Series ATL225-5C



**Collet Chuck Order No.**  
ATL225-5C

- Powered by air
- Small foot print
- Low cost
- Easy to install
- High accuracy less than 0.005mm TIR
- Repeats on duplicate parts +/- 0.008mm
- Dead length design
- For best accuracy use high quality Crawford Collets
- Lever or foot pedal actuated
- Low maintenance with oil mist lubrication system
- High resistance to coolant and chip penetration
- Low maintenance, long life

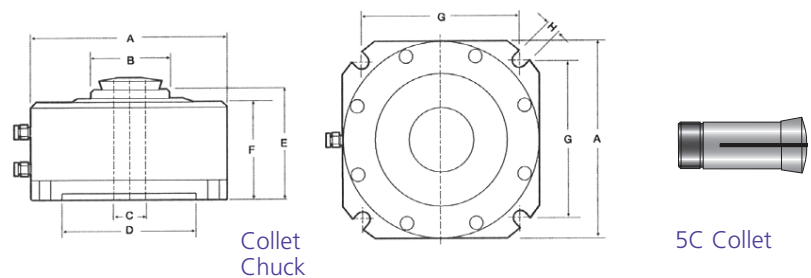

Collet Chuck	ATL225-5C
A	144mm (5.67")
B	55mm (2.17")
C	26mm (1.02")
D	100mm (3.94")
E	95mm (3.74")
F	75mm (2.95")
G	118mm (4.65")
H	8.5mm (0.33")

Specifications	ATL225-5C
Collet Type	5C Collets
Max. RPM	4000
Air Pressure	3-8 kg/cm <sup>2</sup> (42-114 psi)
Through Hole Dia	26mm (1.02")
Chuck Weight	9.4kg (20.7lbs)
Grip Force	13,000 lbs @ 100 psi