

5C & 16C Dead Length Power Chucks

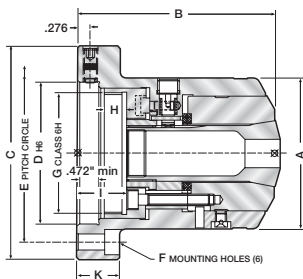

- Setrite four-screw adjustment feature allows accuracy adjustment to virtually zero, eliminating any error in the collet
- Main spindle and sub-spindle CNC chuck applications
- Accuracy guaranteed to .005mm TIR from rear mounting register and working collet taper
- Repeatability is .005mm TIR
- Hardened and ground main body and cone
- Speeds up to 6000 rpm



Straight Recessed



5C Collet

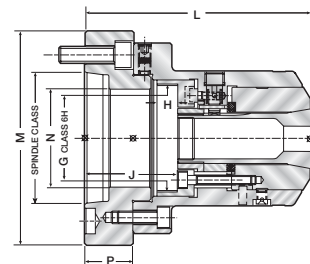

With A5 or A6 Mount



16C Collet

Dimensions shown in inch/mm	For 5C Type Collets		For 16C Type Collets		
St Recess Model No.	B390	B390	B685	B685	B685
w/Mount Model No.	A352	A345	B649	A412	A213
Mount	A2-5	A2-6	A2-5	A2-6	140 x 6
Capacity Hex	21.5	21.5	35	35	35
Capacity Square	17.8	17.8	29	29	29
A	85	85	110	110	110
B	111	111	138	138	138
C	120	120	155	155	155
D	80	80	94	94	94
E	100	100	130	130	130
F	M8	M8	M10	M10	M10
G Thread	M68 x 1.5	M68 x 1.5	M88 x 1.5	M88 x 1.5	M88 x 1.5
H	13	13	13	13	13
J	28-25	28-25	28-24	28-24	28-24
K	24	24	22	22	22
L	141	141	161	168	161
M	135	165	155	165	155
N	62	62	77	77	77
P	30	30	23	30	23
Maximum RPM	6000	6000	6000	6000	6000
Drawbar Force (kN)	18	18	24	24	24
Clamping Force (kg)	4490	4490	5987	5987	5987
Chuck Weight	6.8 kg	8.1kg	10.7 kg	11.8 kg	11.1kg

5C & 16C Dead Length Power Chucks

DIN 6353 Straight Recess Mounts



- Short overall length ideal for main or sub-spindle applications
- In second operation work, shouldered components can be stopped against the face of the collet
- Accuracy guaranteed to .005mm TIR from rear mounting register and working collet taper
- Repeatability is .005mm TIR
- Hardened and ground main body and cone
- Speeds up to 6000 rpm

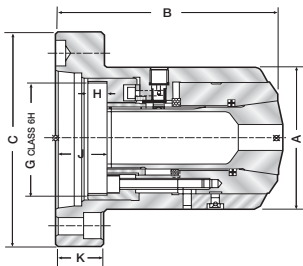

A2 Mount

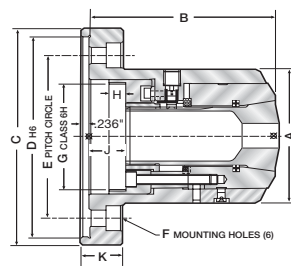

DIN 6353 Mounts

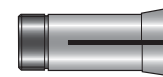

5C Collet

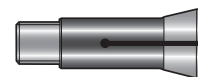

16C Collet

Chuck Type	For 5C Type Collets			For 16C Type Collets			
	Chuck Model No.	D956	C336	C338	B649	C170	C340
Mount	A2-5	A2-6	140 x 6	A2-5	A2-6	A2-8	170 x 6
Capacity Round	27	27	27	41.3	41.3	41.3	41.3
Capacity Hex	22	22	22	35	35	35	35
Capacity Square	18	18	18	29	29	29	29
A	85	85	85	110	110	110	110
B	117	117	117	153	144	161	144
C	135	165	160	155	165	220	200
D	-	-	140	-	-	-	170
E	-	-	104.8	-	-	-	133.4
F	-	-	M10	-	-	-	M12
G thread	M68 x 1.5	M68 x 1.5	M68 x 1.5	M88 x 1.5	M88 x 1.5	M88 x 1.5	M88 x 1.5
J	34-31	34-31	34-31	36-32	34-30	34-30	34-30
K	25	30	30	47	30	30	30
Maximum RPM	6000	6000	6000	6000	6000	4500	4500
Drawbar Force (kN)	18	18	18	24	24	24	24
Clamping Force (kg)	4490	4490	4490	5987	5987	5987	5987
Approx. Chuck Weight	4.8 kg	5.9 kg	5.6 kg	10.9 kg	9.3 kg	11.8 kg	10.7 kg